

# City of La Cañada Flintridge Neighborhood Meeting



## I-210 Sound Walls Phase IV Sound Wall S318



# Agenda



- ❖ Introduction
- ❖ Project Background
  - ❖ Phase I
  - ❖ Phase II
  - ❖ Phase III
  - ❖ Phase V
  - ❖ Phase IV
- ❖ S318 Wall Alignment
- ❖ Typical Sections
- ❖ Aesthetics
- ❖ Project Information
  - ❖ Schedule
  - ❖ Construction
- ❖ Project Contact
- ❖ Questions

# Introduction

- ❖ City Council
- ❖ City Manager
- ❖ Soundwall Committee
- ❖ City Staff
- ❖ City Design Consultant
- ❖ Caltrans





# Project Background

- ❖ City identified need and funded studies
- ❖ Noise Barrier Scope Summary Report and Noise Study (NBSSR) Completed 2007
  - ❖ 23 sound walls identified
  - ❖ Sound walls designed/constructed in phases

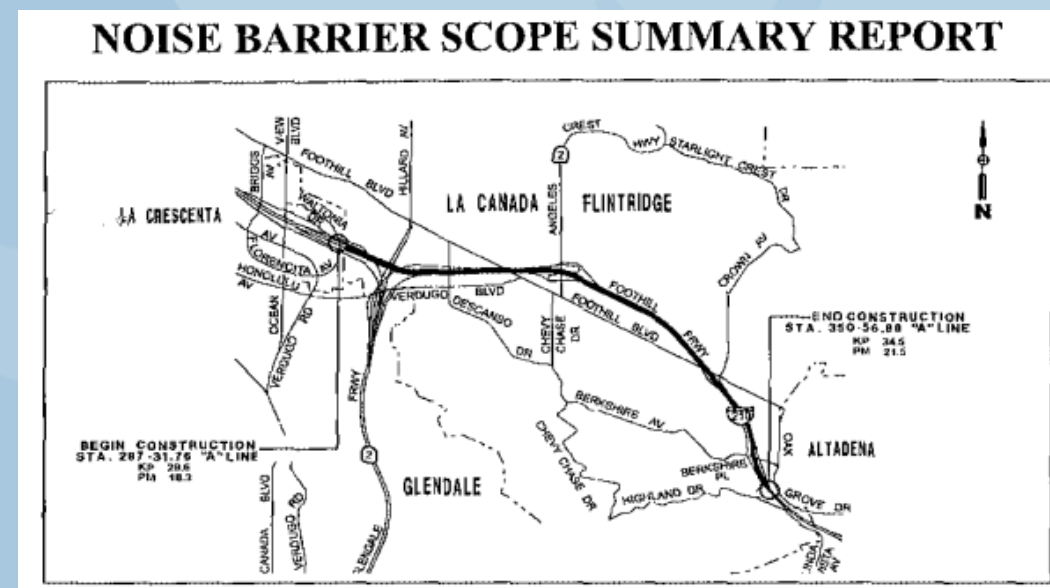

# Project Background – Phase I

- ❖ Sound Wall 310 (a portion), 338 and 341
- ❖ Construction completed in 2015
- ❖ Design and construction cost \$4.9M

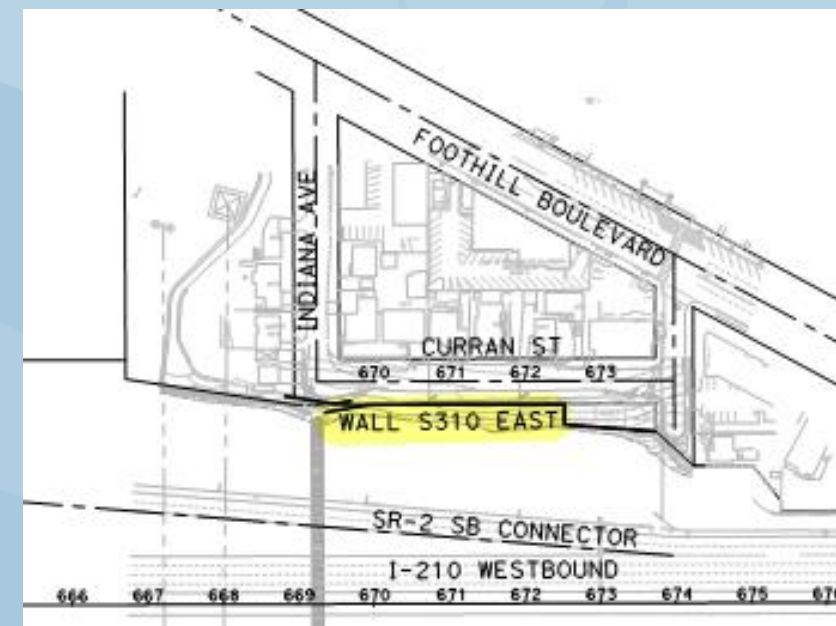
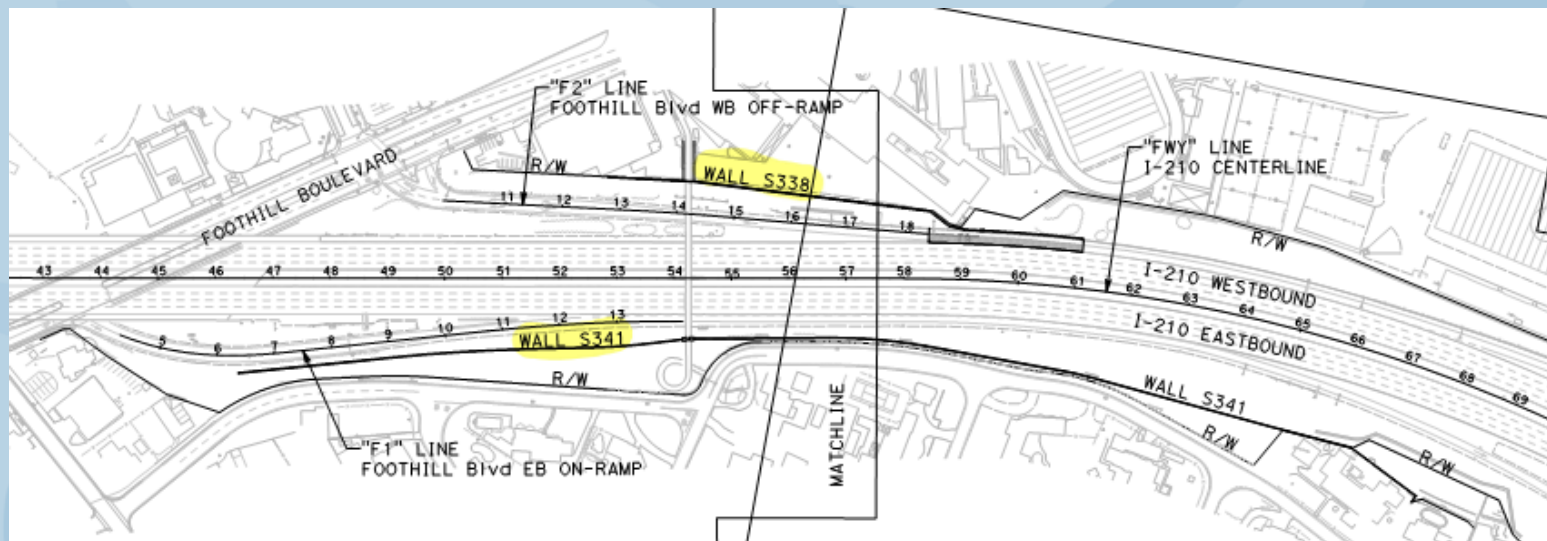



# Project Background – Phase II

- ❖ Sound Wall 307
- ❖ Along Eastbound Rte-210 from west of La Tour Way to Alta Cañada Road
- ❖ Design and construction cost approximately \$2.3M.
- ❖ Construction to begin Spring 2023

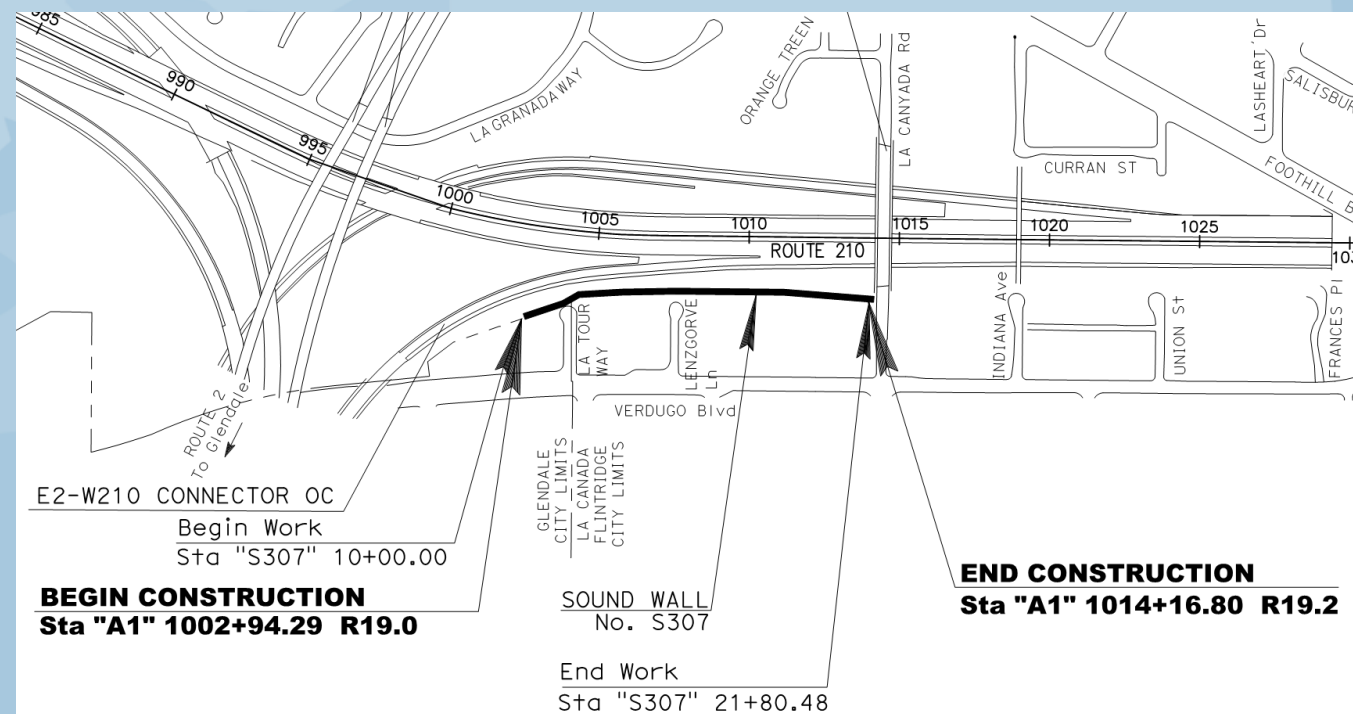





# Project Background – Phase III

- ❖ Sound Walls S311, S335 and S336
- ❖ Currently under construction
- ❖ Design and construction cost: approximately \$12M.

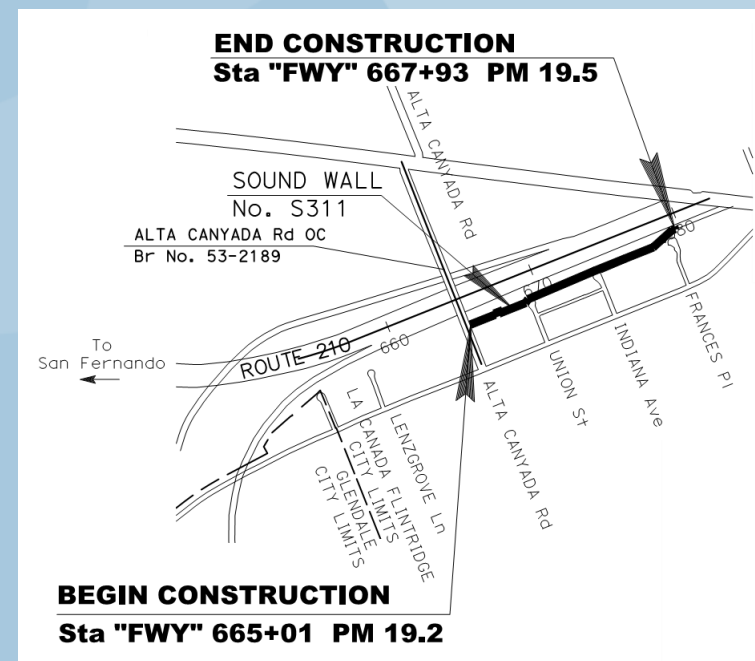
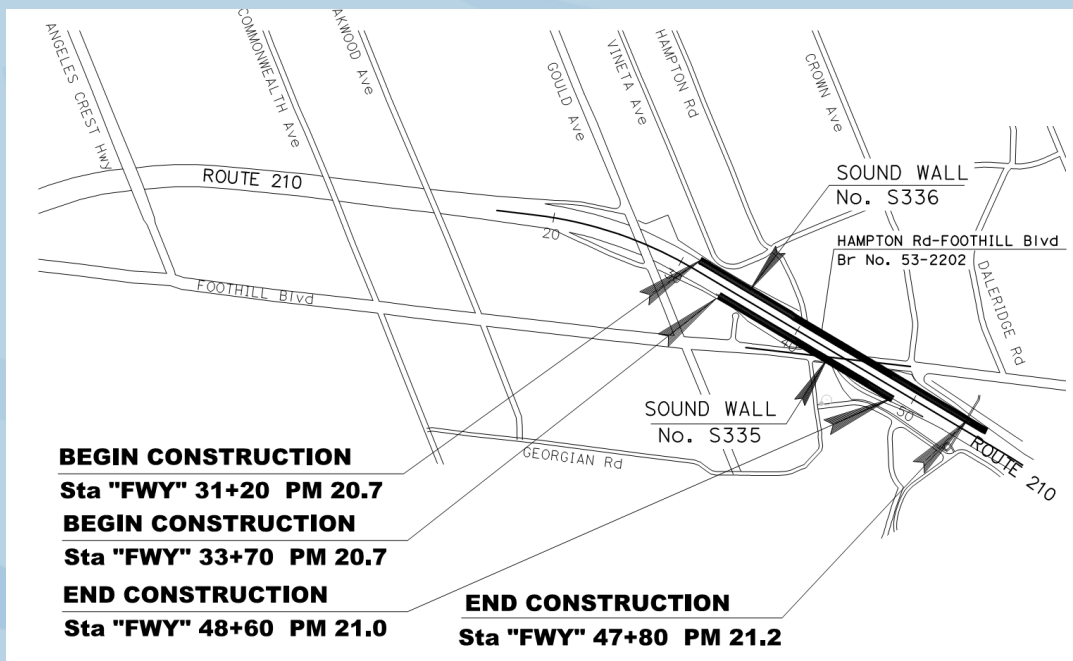



## Project Background – Phase V

- ❖ Sound Walls 301, 303, 304, 308, 310 (portion), 322, 323, 325, 328, 329, 332, 346, 350
- ❖ Anticipated design and construction cost approximately \$35M.
- ❖ Currently Unfunded, City Seeking Funds







# Project Background – Phase IV

- ❖ Sound Walls 298, 300, 318, 326
- ❖ Construction anticipated to begin in Spring 2023.
- ❖ Anticipated design and construction cost approximately \$11M.

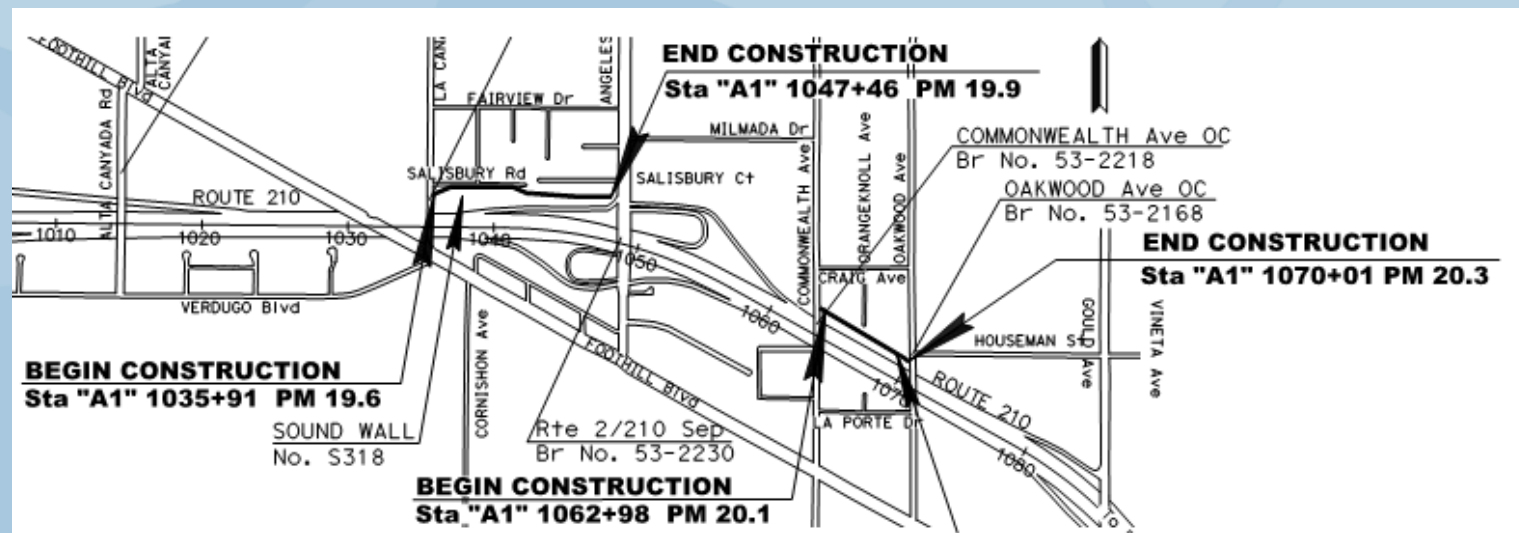
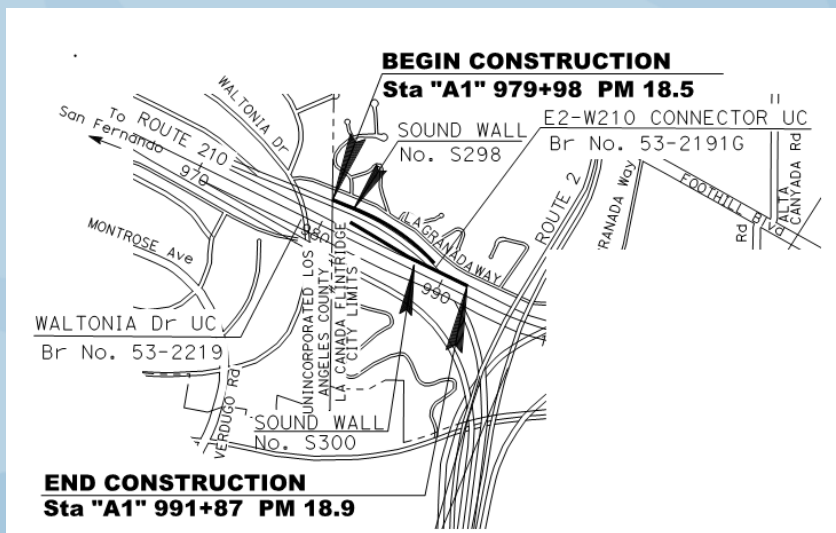

# Sound Wall S318



- ❖ Site Plan
- ❖ Wall Heights
- ❖ Tree Removals
- ❖ Planting Plan
- ❖ Wall Aesthetics
- ❖ Construction Activities



# Sound Wall S318 - Site Plan

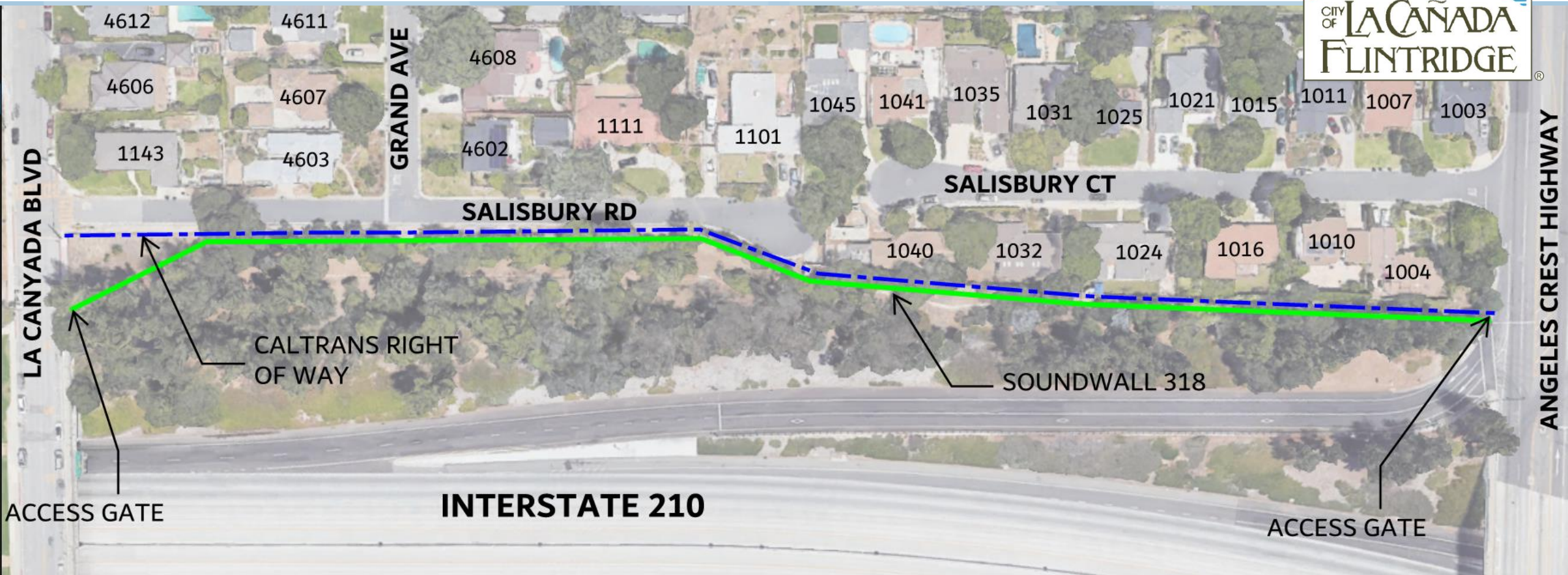



# Sound Wall S318 - Wall Height

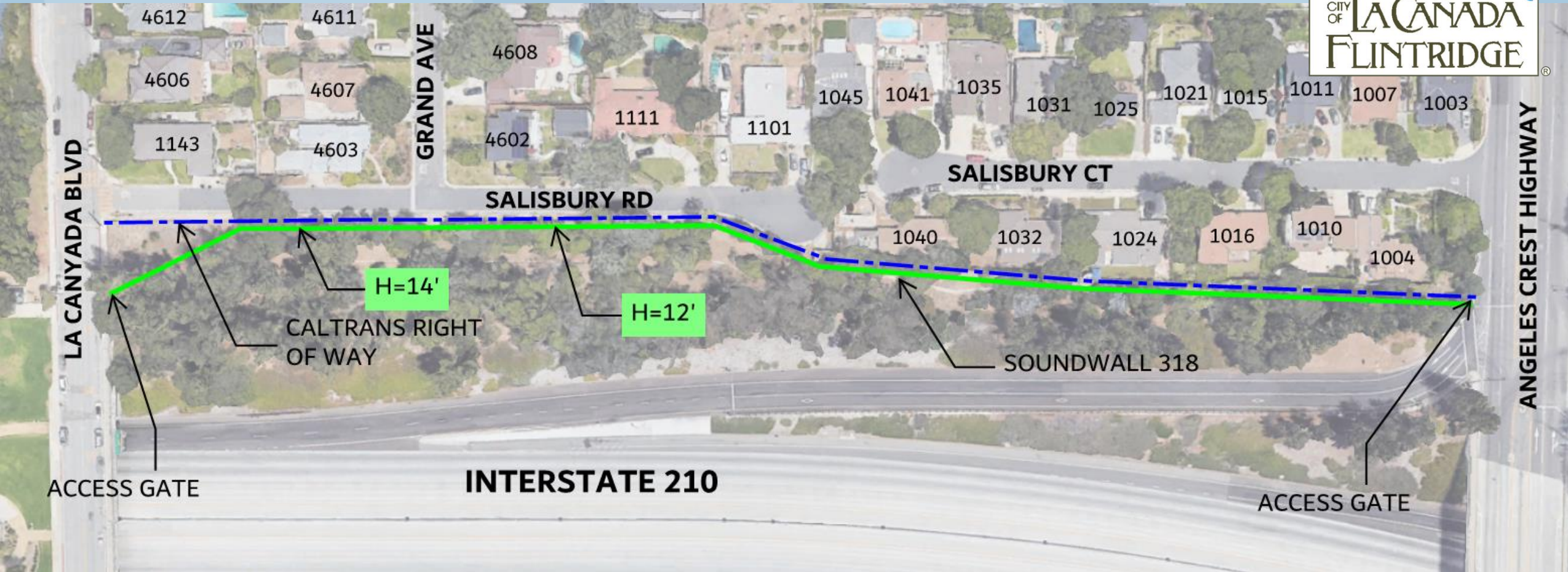



# Typical Section

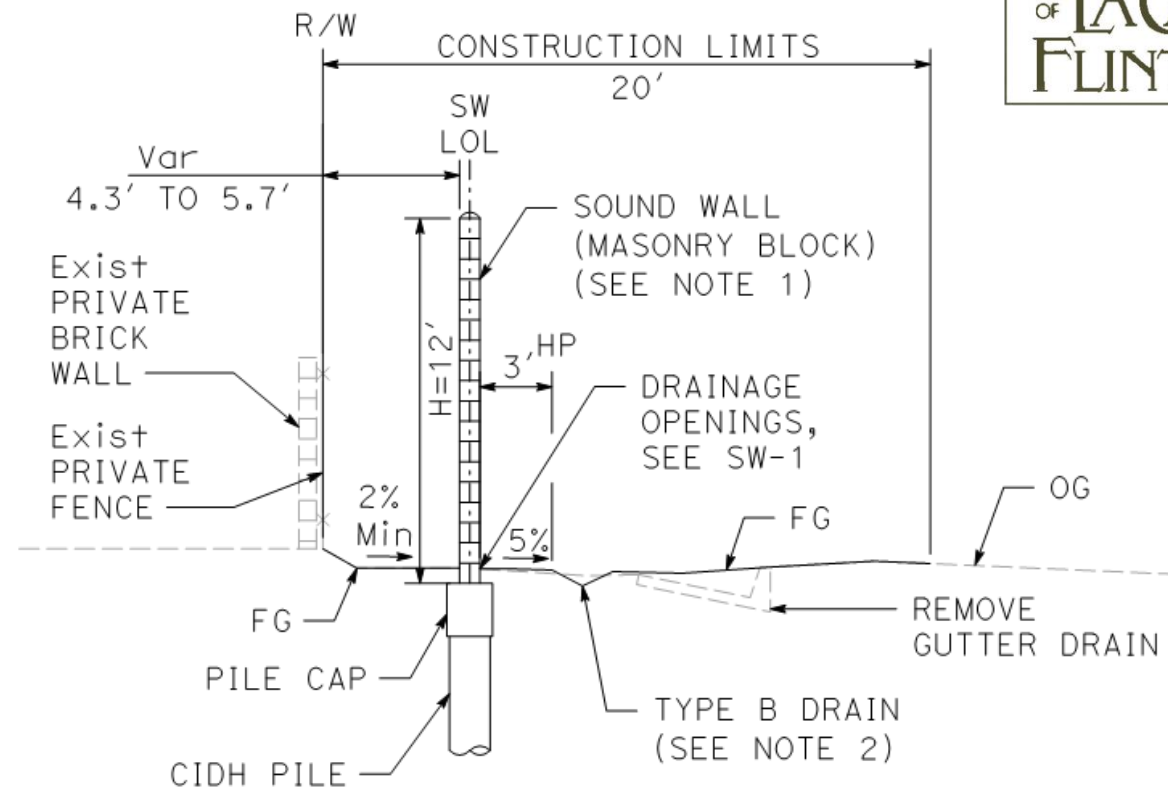
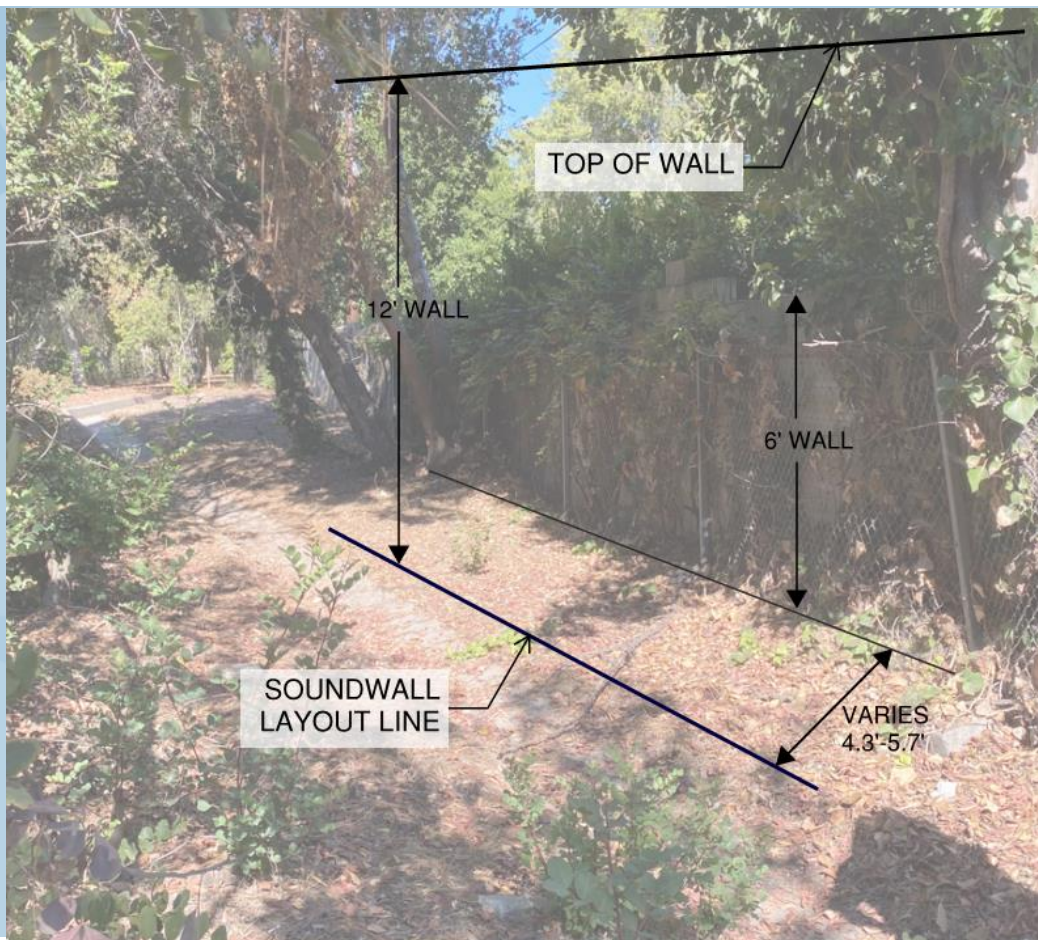

## **SOUND WALL NO. S318**

"S318" Sta 16+89.14 TO Sta 22+41.95

# Sound Wall S318 - Tree Removal

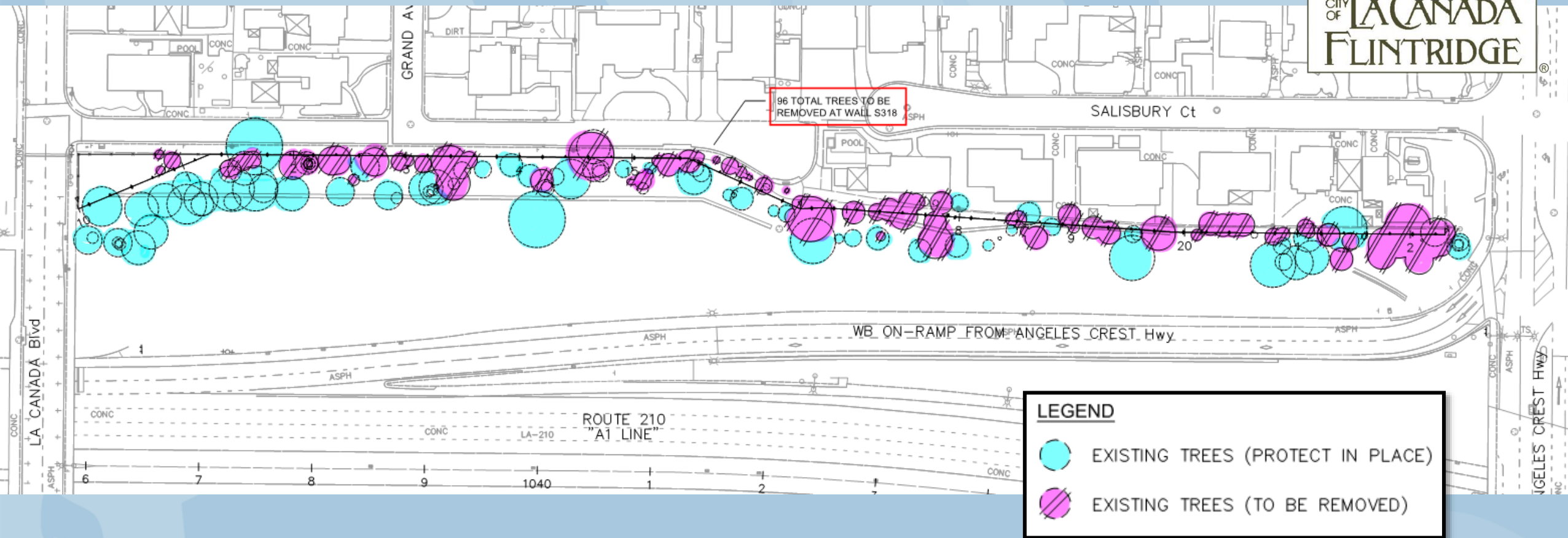





# Sound Wall S318 - Planting Plan

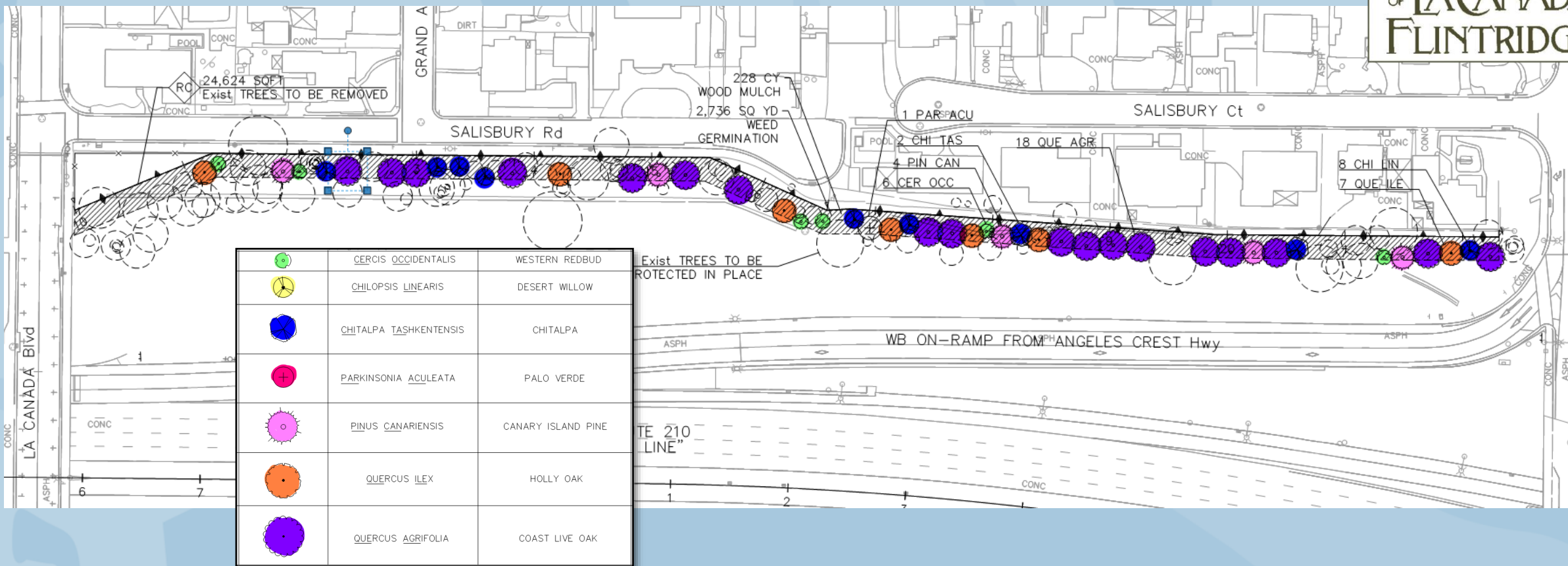

# Tree Palette



Canary Island Pine

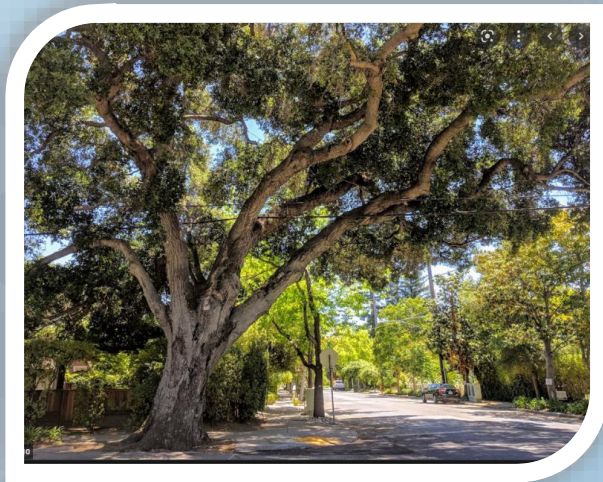

Coast Live Oak



Palo Verde



Holly Oak



# Tree Palette

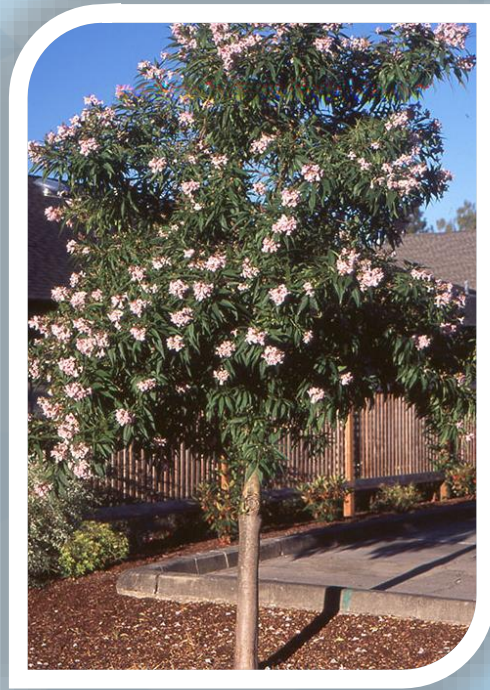

Chitalpa

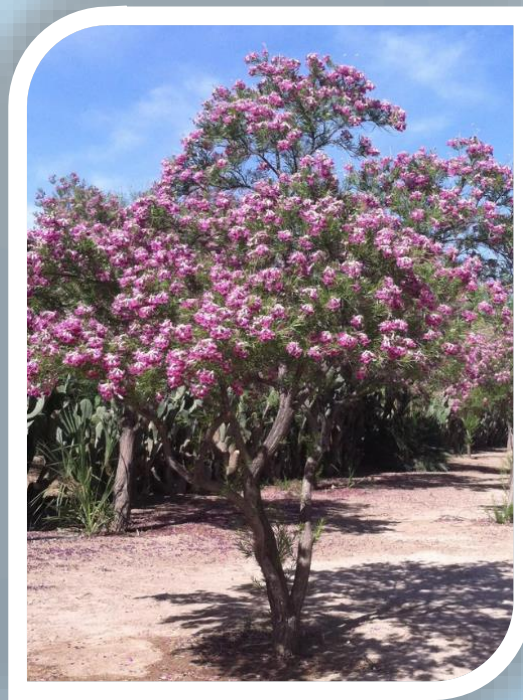

Desert Willow



Western Rosebud





# Aesthetics





# ACCESS & STAGING AREA

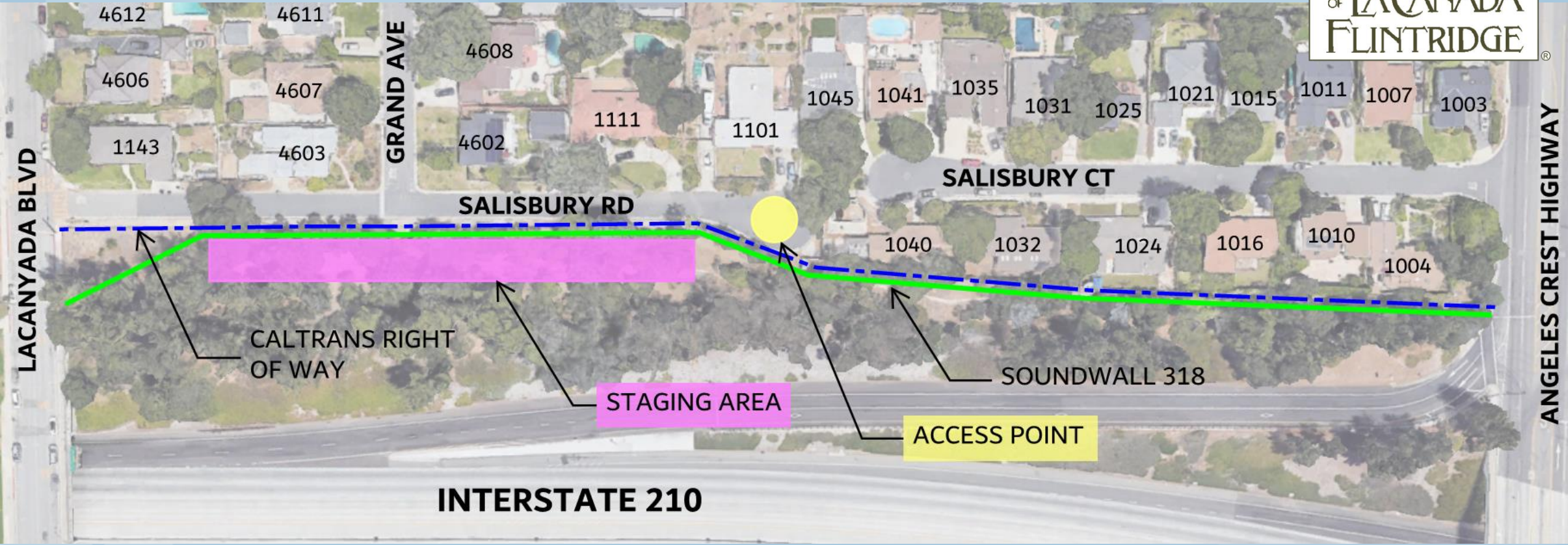
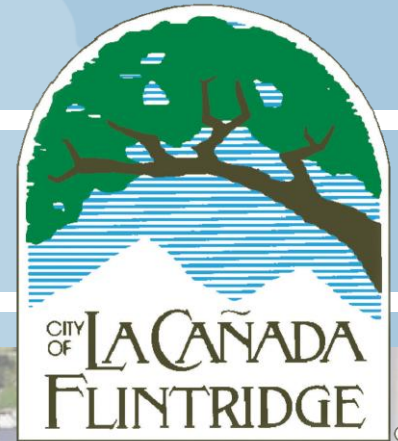

# Construction

- ❖ Schedule
  - ❖ Begin construction Spring 2023
  - ❖ Completion Summer 2024
- ❖ Contractor Access Points
- ❖ Hours of Construction
  - ❖ 7 A.M. TO 3:30 P.M.
- ❖ Construction Activities





# Soundwall Construction





# Soundwall Construction





# Soundwall Construction



# Project Contact



## ❖ Who to Contact for Project Information

❖ Maged El-Rabaa, P.E.

❖ Email: [cityengineer@lcf.ca.gov](mailto:cityengineer@lcf.ca.gov)

❖ Website: <https://cityoflcf.org>



# Questions

