

City of La Cañada Flintridge Neighborhood Meeting

I-210 Soundwalls
Phase II
Soundwall S307



Agenda



- ❖ Introduction
- ❖ Project Background
 - ❖ Phase I
 - ❖ Phase III
 - ❖ Phase IV
 - ❖ Phase V
- ❖ Phase II
 - ❖ SW307 Alignment
 - ❖ Typical Sections
 - ❖ Aesthetics
- ❖ Project Information
 - ❖ Schedule
 - ❖ Construction
- ❖ Project Contact
- ❖ Questions

Introduction



- ❖ City Council
- ❖ City Manager
- ❖ Soundwall Committee
- ❖ City Staff
- ❖ City Design Consultant
- ❖ Caltrans



Project Background



- ❖ City identified need and funded studies
- ❖ Noise Barrier Scope Summary Report and Noise Study (NBSSR) Completed 2007
 - ❖ 23 soundwalls identified
 - ❖ Soundwalls designed/constructed in phases

NOISE BARRIER SCOPE SUMMARY REPORT

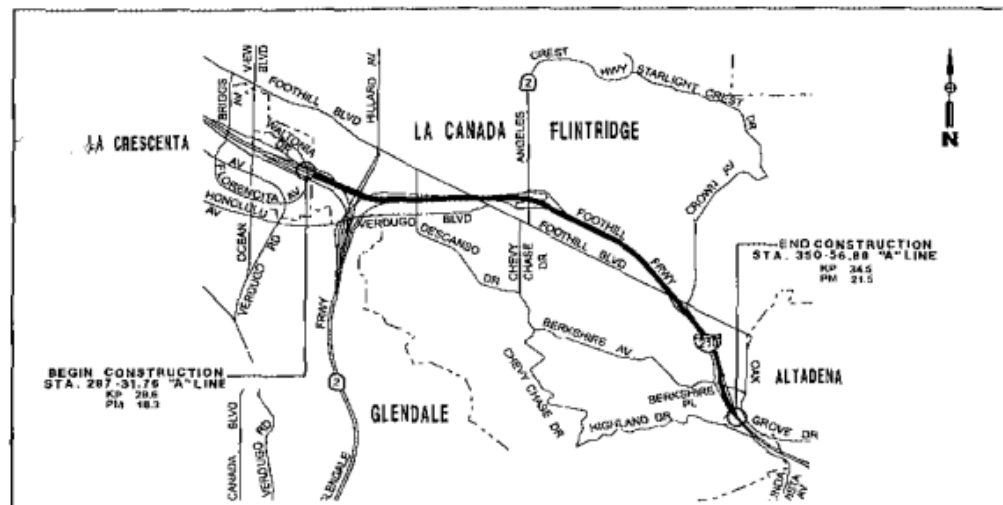

Project Background – Phase I



- ❖ Soundwall 310 (a portion), 338 and 341
- ❖ Construction completed in 2015
- ❖ Design and construction cost \$4.9M

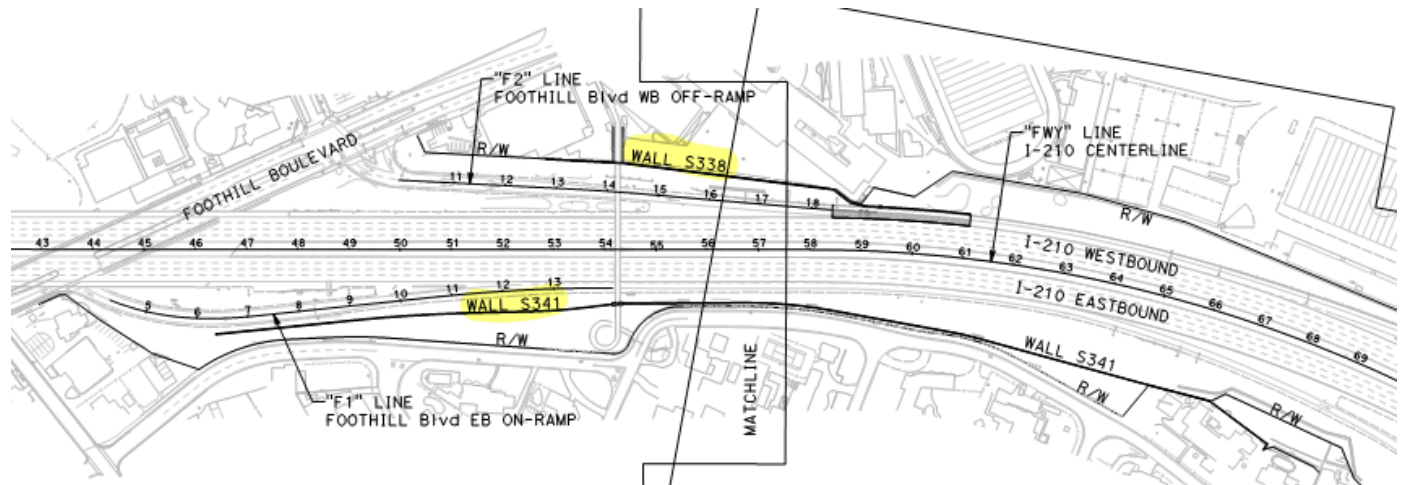
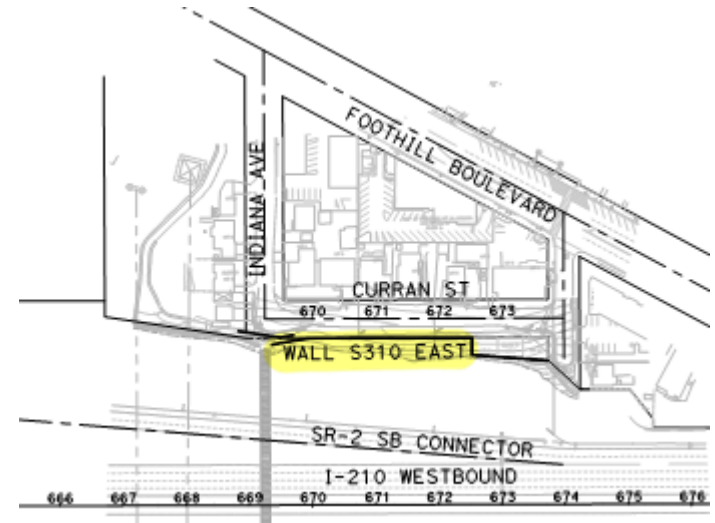

Project Background – Phase III



- ❖ Soundwall 311, 335 and 336
- ❖ Currently under construction.
- ❖ Estimated Completion Date: March 2023
- ❖ Design and construction cost: approximately \$12M.

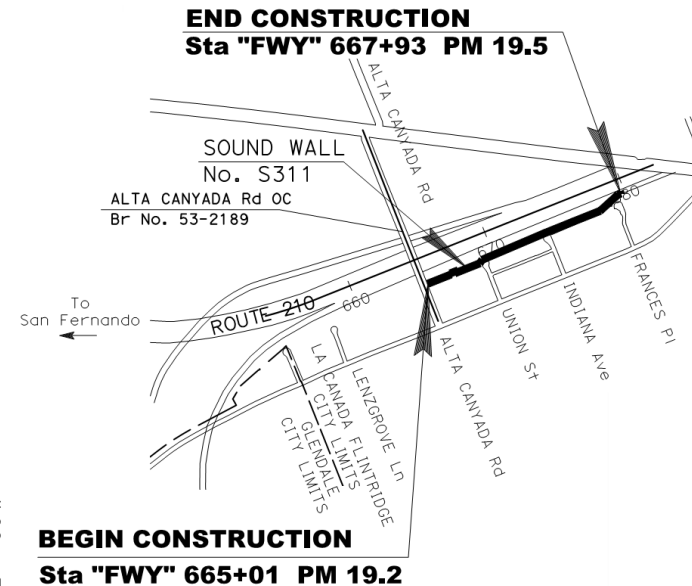
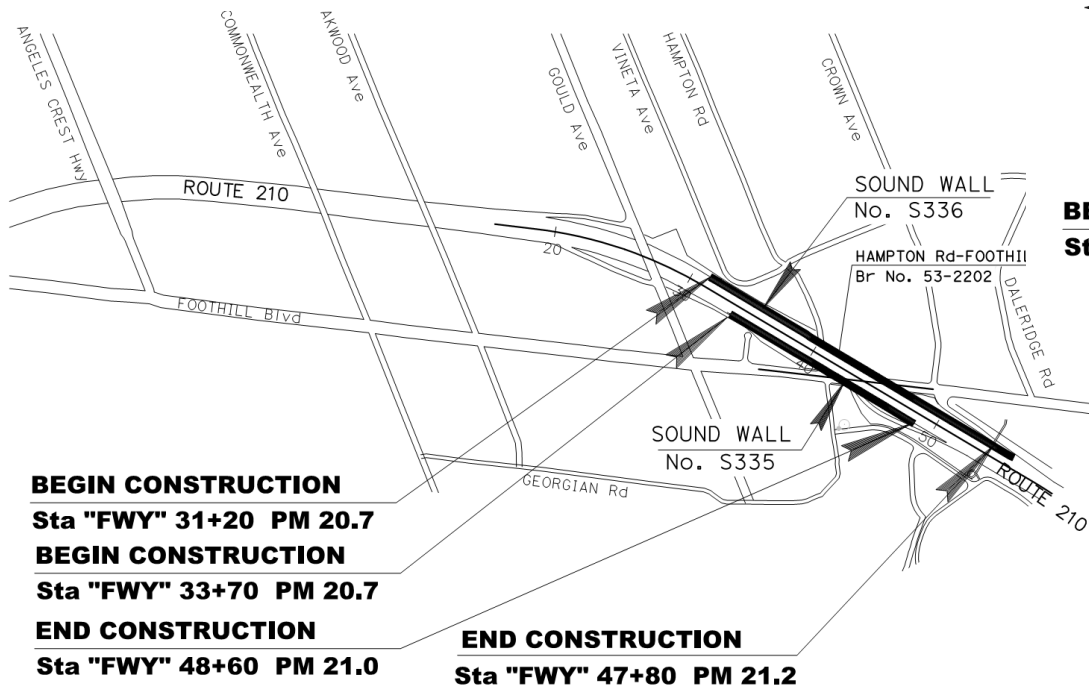

Project Background – Phase IV

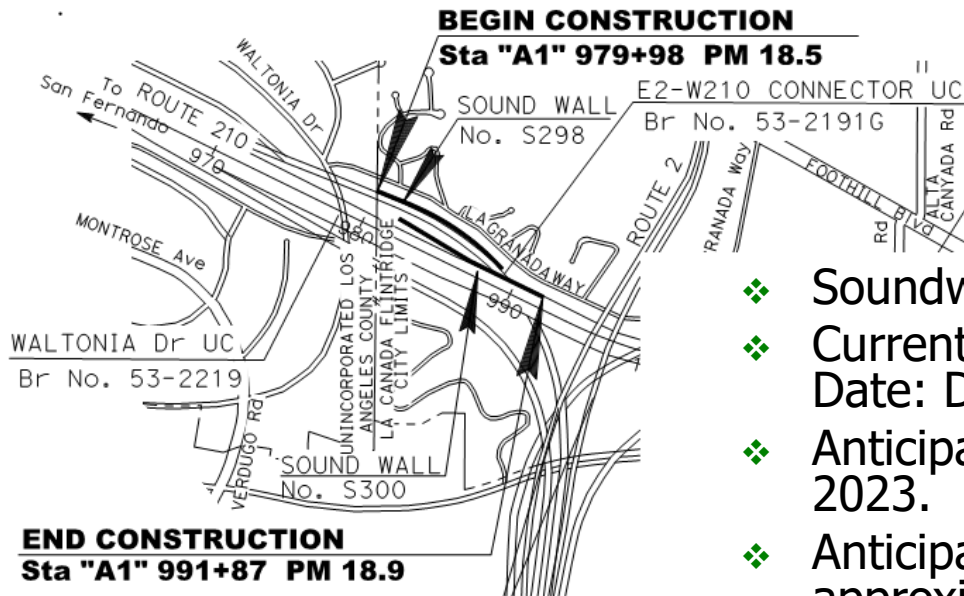

- ❖ Soundwall 298, 300, 318, 326
- ❖ Currently in design (Estimated Completion Date: December 2022).
- ❖ Anticipated begin construction: First Quarter 2023.
- ❖ Anticipated design and construction cost approximately \$11M.

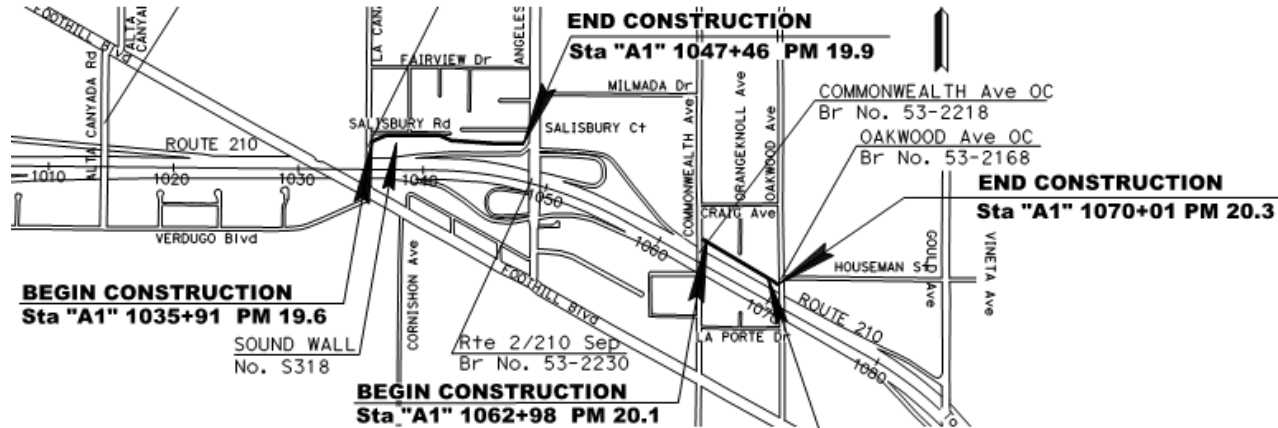

Project Background – Phase V



- ❖ Soundwall 301, 303, 304, 308, 310 (portion), 322, 323, 325, 328, 329, 332, 346, 350
- ❖ Anticipated design and construction cost approximately \$35M.
- ❖ Currently Unfunded, City Seeking Funds

Project Background – Phase II



- ❖ Soundwall 307
- ❖ Along Eastbound I-210 from west of La Tour Way to Alta Canyada Road
- ❖ Design and construction cost approximately \$2.3M.

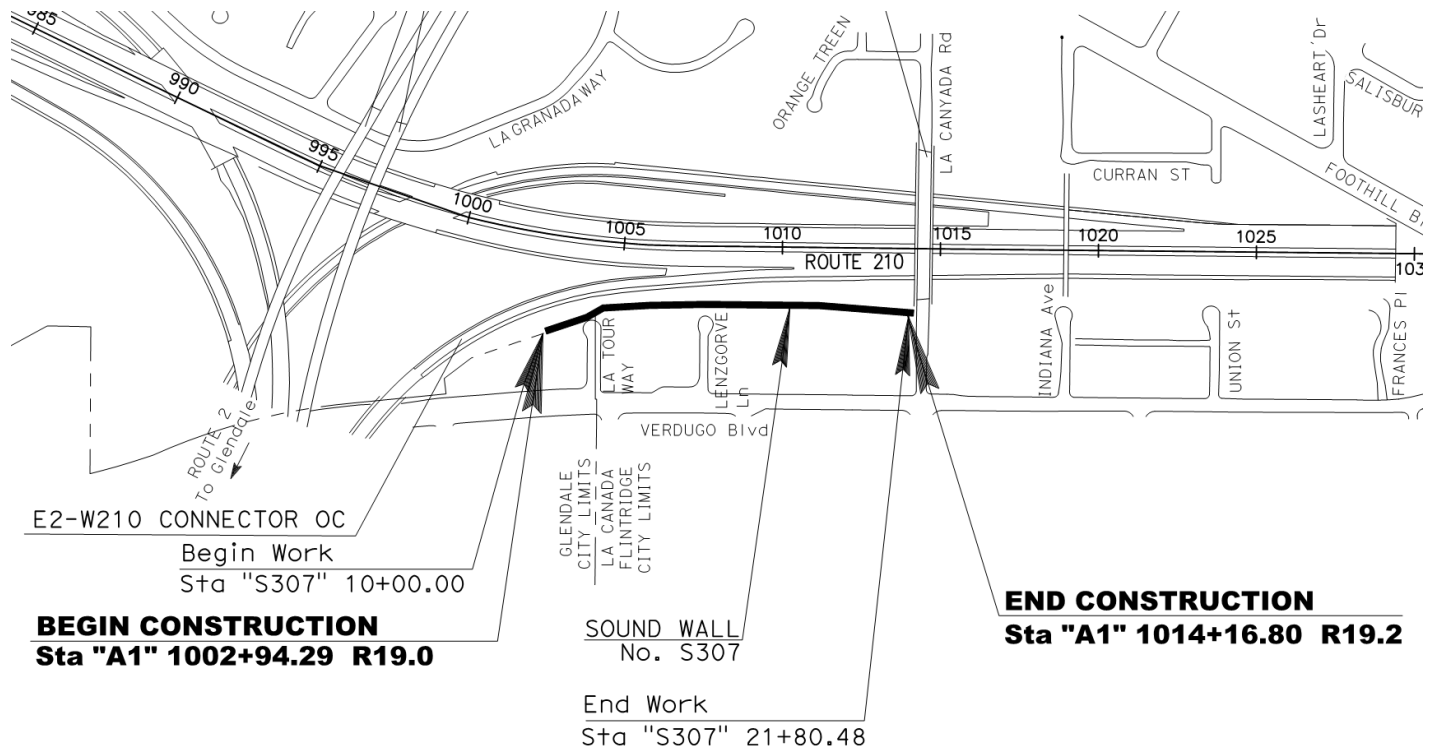

Soundwall S307



- ❖ Site Plan
- ❖ Wall Heights
- ❖ Tree Removals
- ❖ Planting Plan
- ❖ Wall Aesthetics
- ❖ Construction Activities

Soundwall S307 Site Plan

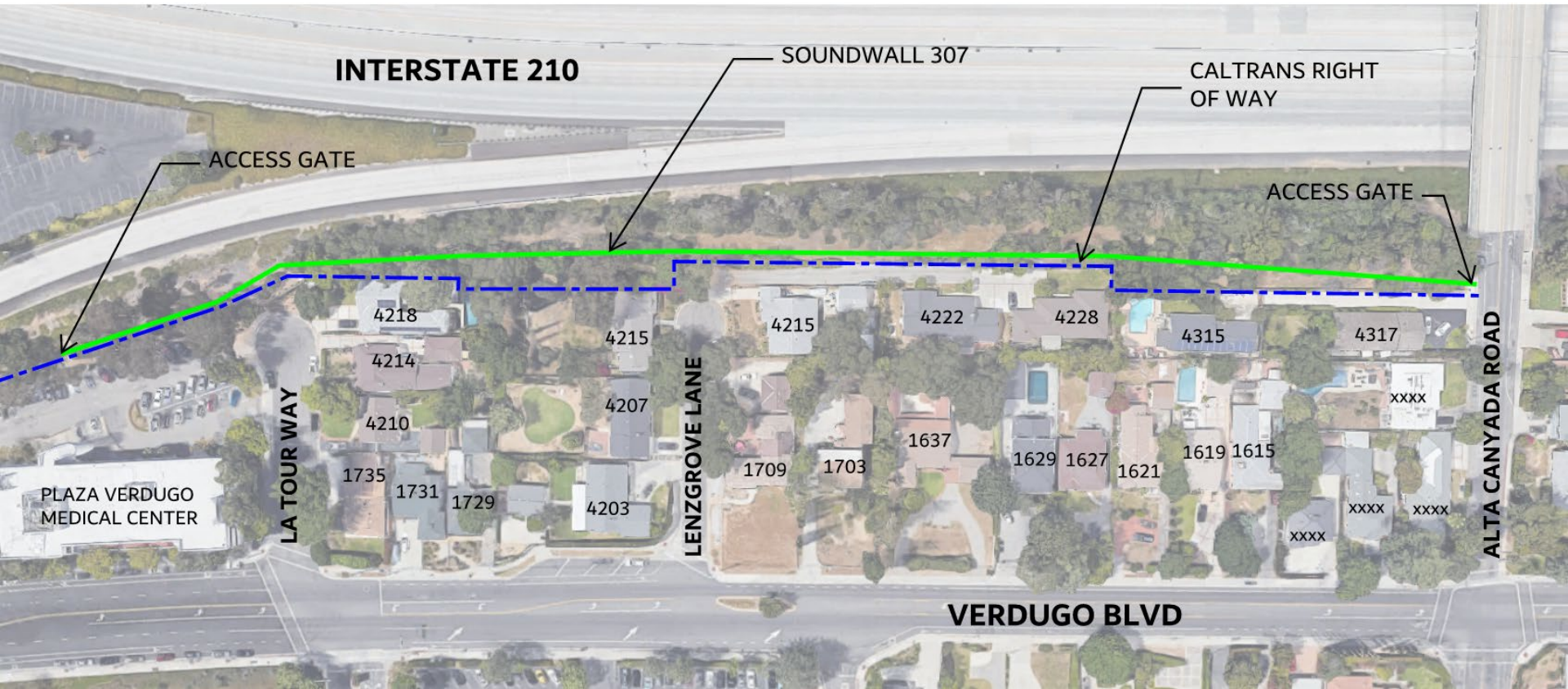

Soundwall S307 Wall Heights

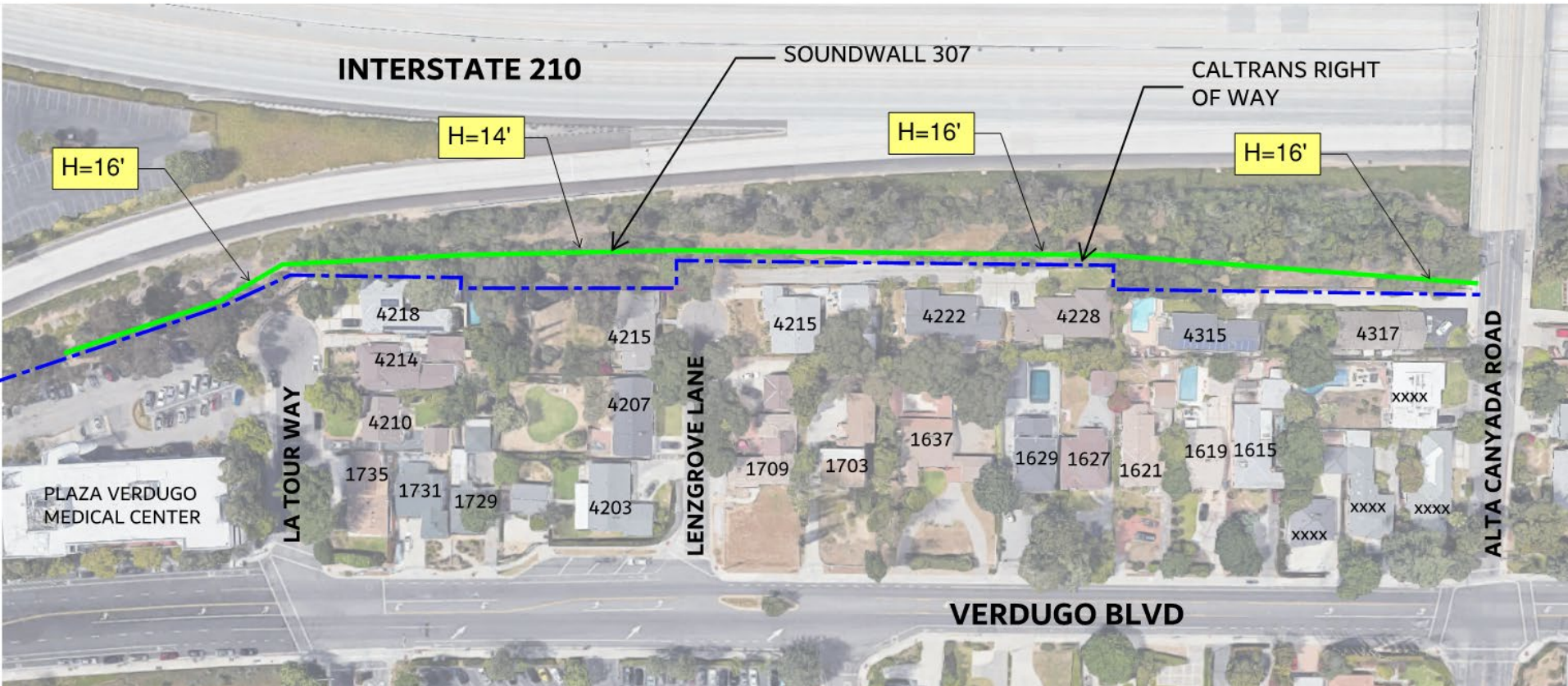

Typical Section

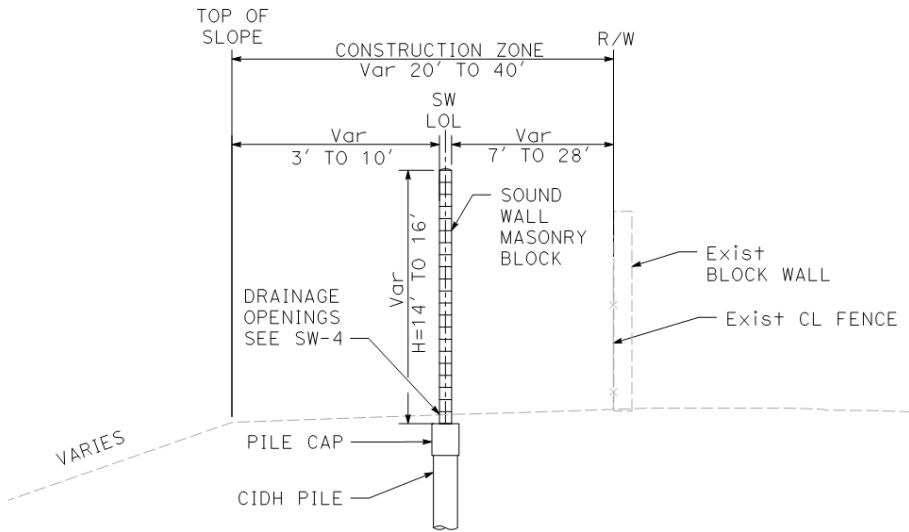

SOUND WALL NO. S307

"S307" Sta 15+00.00 TO Sta 16+00.00 & Sta 17+00.00 TO 20+00.00



Wall Height Mock Up

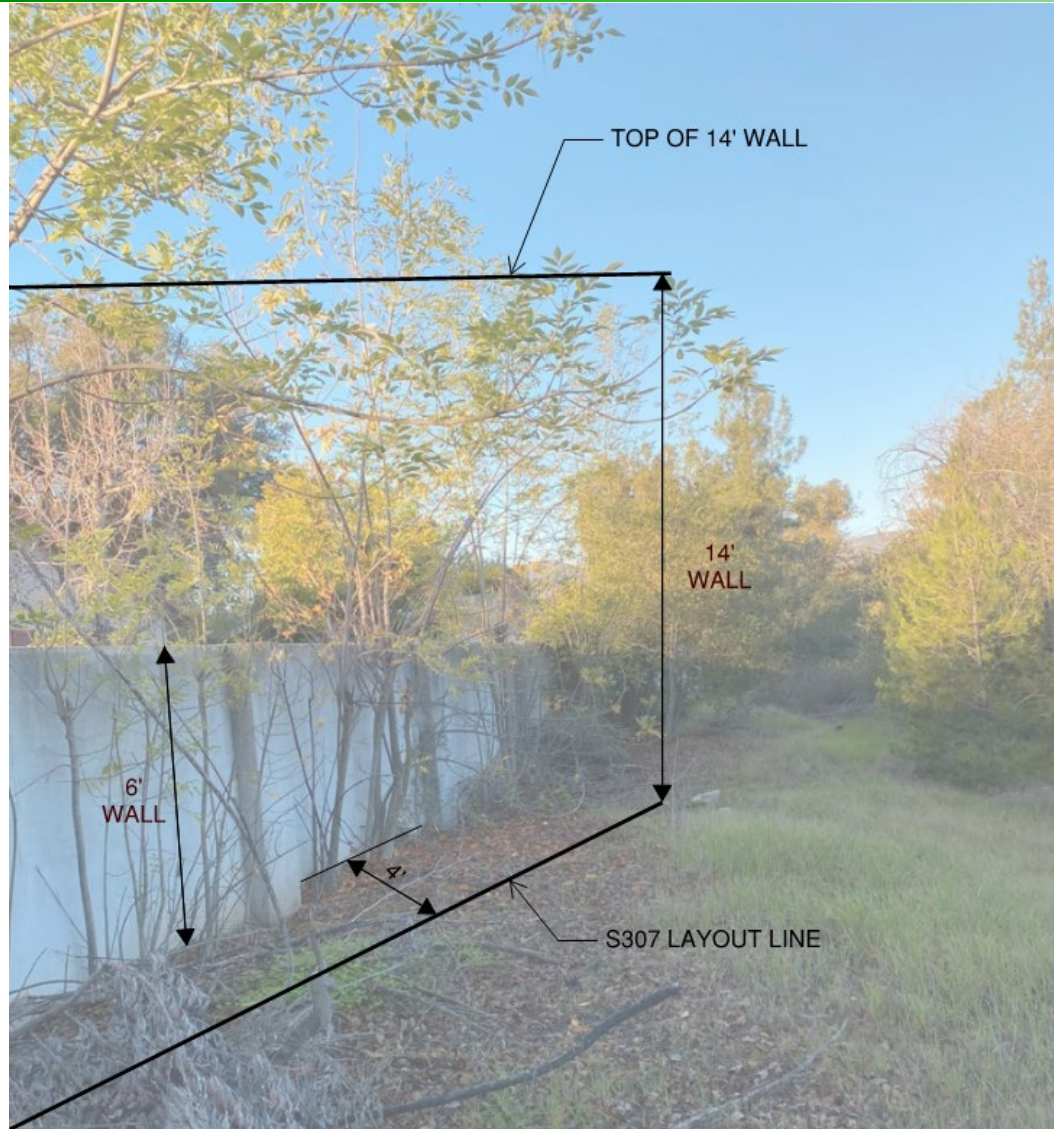

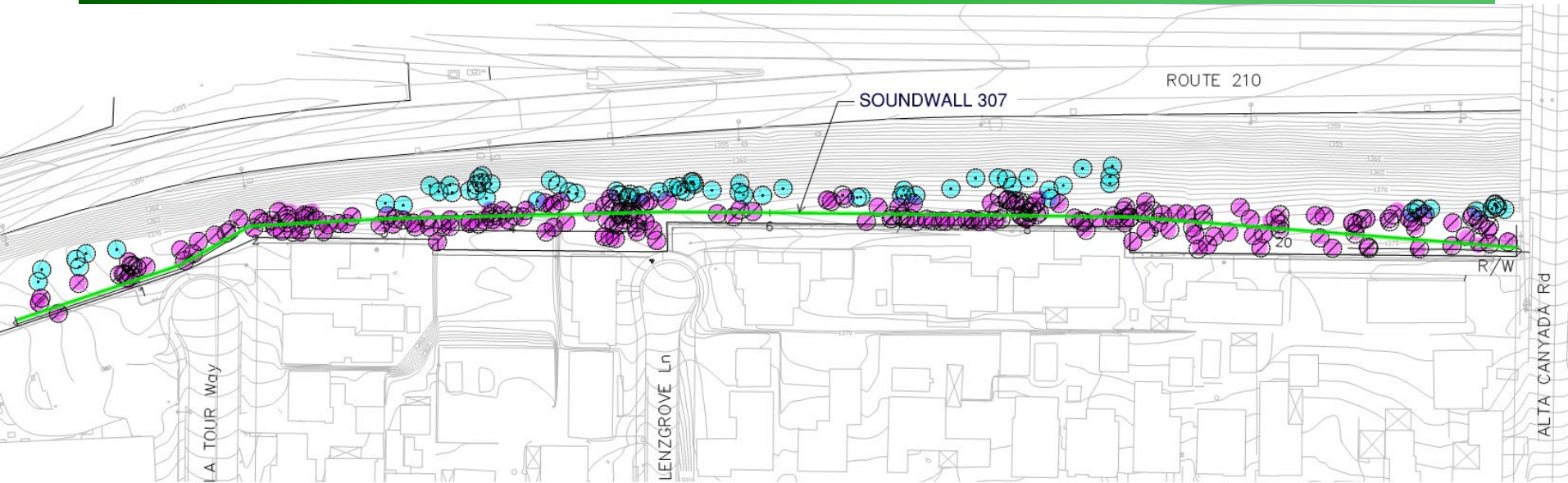

Tree Removal



EXISTING TREES TO BE REMOVED

DESCRIPTION		
PLANT TOTAL	BOTANICAL NAME	COMMON NAME
1	ALLAMANDA CATHARTICA	GOLDEN TRUMPET
2	CUPANIOPSIS ANACARDIOIDES	CARROT WOOD
13	EUCALYPTUS CLADOCALYX	SUGAR GUM
3	EUCALYPTUS GLOBULUS	BLUE GUM
1	FICUS BENJAMINA	FICUS
43	FRAXINUS UHDEI	EVERGREEN ASH
1	KOELREUTERIA BIPINNATA	CHINESE FLAME
1	LAGERSTROEMIA INDICA	CRAPE MYRTLE
2	OLEA EUROPAEA	OLIVE
1	PINUS CANARIENSIS	CANARY ISLAND PINE
10	PINUS HALEPENSIS	ALEPPO PINE
139	QUERCUS AGRIFOLIA	COAST LIVE OAK
13	ULMUS PARVIFOLIA	CHINESE ELM
1	WASHINGTONIA ROBUSTA	MEXICAN FAN PALM
231	TOTAL	

LEGEND

-  EXISTING TREES (PROTECT IN PLACE)
-  EXISTING TREES (TO BE REMOVED)

Planting Plan

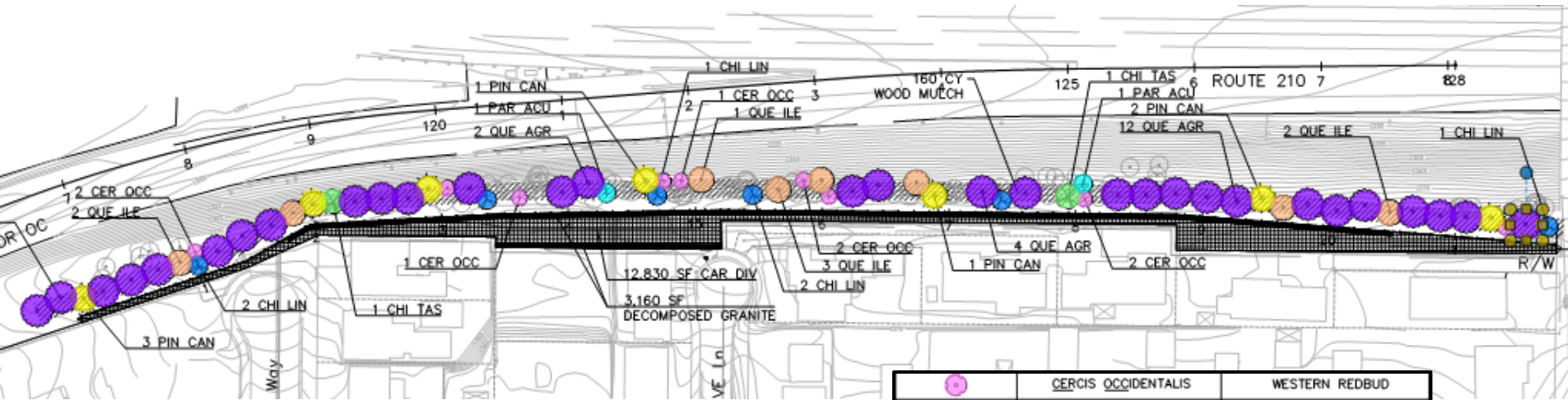

	<u>CERCIS OCCIDENTALIS</u>	WESTERN REDBUD
	<u>CHILOPSIS LINEARIS</u>	DESERT WILLOW
	<u>CHITALPA TASHKENTENSIS</u>	CHITALPA
	<u>PARKINSONIA ACULEATA</u>	PALO VERDE
	<u>PINUS CANARIENSIS</u>	CANARY ISLAND PINE
	<u>QUERCUS ILEX</u>	HOLLY OAK
	<u>QUERCUS AGRIFOLIA</u>	COAST LIVE OAK

Tree Palette



Coast Live Oak



Canary Island
Pine



Palo Verde



Holly Oak

Tree Palette



Chitalpa



Desert Willow



Western Rosebud

Aesthetics



Construction



- ❖ Schedule
- ❖ Traffic Control
- ❖ Contractor Access Points
- ❖ Hours of Construction
7 A.M. TO 3:30 P.M.
- ❖ Construction Activities

Soundwall S307 – Access



Soundwall Construction



Soundwall Construction



Soundwall Construction



Soundwall Construction



Project Contact



- ❖ Who to Contact for Project Information
 - ❖ Maged El-Rabaa, P.E.
 - ❖ Email: cityengineer@lcf.ca.gov
 - ❖ Website: <https://cityoflcf.org/>

Questions

